

Late Ku.Durga K.Banmeru Science College Lonar

Dist.Buldana -443302

4.1 Physical Facility

4.1.1: Availability of adequate infrastructure and physical facilities viz., classrooms, laboratories, ICT facilities, cultural activities, gymnasium, yoga centre etc. in the institution

Response: The college provides education to student in rural area. Our college has provides art infrastructure and facilities for the teaching learning process for students. The college development committee (CDC) has provided the adequate infrastructure for the development of the college considering the rural area. All classrooms of college are fully ventilated, latest blackboards, LCD projector joining system, desk benches, fans, lights etc. Some classrooms are fitted smart boards and CC-TV cameras in which students across both the campus can attend any lecture. The college campus is safe and secure building with security CC-TV cameras. The total college campus is covered by CC-TV camera. We also have well equipped computer lab, which are used by the students for lab-based classes, practical's.It also provides different software's. As well as faculty members are used computer lab for teaching learning and research process. Both the campus are fully Wi-Fi enabled in which students can access the internet from each and every corner of the college campus. It also helps the students and faculties to intersact with each other by sending any documents, notes, assignments etc. The college has a seminar hall/conference hall, laboratories and skill based (B.Voc) lab. In this laboratories all equipment are available.

Campus-Spread over 6 acres in a verdant green campus. In our college has 7 Class room with ergonomic furniture for students.

Skill Lab- Institute make one skill lab for provides a safe training environment in which a learner can be observed and be provided with the feedback necessary to improve. In this lab well equipped as Air conditioner with smart 43 inches LED TV with high speed internet connection. Skill lab also provide microphone in the seating arrangement for the student audio learning.

This lab also available Audio-Visual facility.

Girls Common Rooms –College has facilitate our female students, the Campus has established a spacious and comfortable common room for gilrs. This space has been designed to give female students a place to relax, study, have informal discussions in free time available. College has a provision for Girls Common

Room where the girl students may sit, rest and go for recreation. In this room attached washroom with Sanitary Napkin Vending Machine, CCTV etc.

Laboratories-All department like Chemistry, Botany, Zoology, Physics, Electronics, Microbiology and computer Science (With power backup facility for the UG and PG Student) have equipment required for student demonstration is available in all facilities like Electricity, Continuous supply of Gas, Fire Extinguisher, in the laboratory. College have Separate language room and Mathematics department.

ICT Facility-Audio-visual aids are used in the college to make learning easier for the students.

3 smart board attached with computer with internet, facilities have been provided in the college for the convenience of the students in which power point presentation etc. are regularly used on smart boards. Skill Lab also Available in the college.

Ramp & Wheelchair - The College has made arrangements for blind and disabled students. College provide Ramp & wheelchairs. First priority is given Blind and Handicaped student for Exam form, Scholarship Form submission etc.

Sports Ground: A verdant well-manicured multipurpose sports ground is used for Indoor and Outdoor games.

Auditorium Hall: The auditorium with well equipped facility to organized various program. Auditorium hall is used for several purposes such as yoga sessions, self defense workshops, student competitions and practice of extra-curricular activities.

Women Hostel: Increasing mobility of students, to seek the education they desire, raises the demand for hostels. College has Women Residential Hostel with the Capacity of 25 girls. All the facility available in the hostel Seek rooms, Mess, Ramp, Beds, Separate kitchen etc.

Current Building Area in Square Feet

Sr.No	Physical Infrastructure	Area Sq.Ft	Remark
01	Principal Cabin	150	
02	Office	1549	
03	Botany	400	
04	Zoology	400	
05	Physics	825	
06	Chemistry	515	
07	Electronics	400	
08	Auditorium	1250	
09	Library	950	
10	Microbiology	625	
11	Computer Science	625	
12	IQAC Room	144	
13	NSS & Sport	136	
14	Skill Lab	272	
15	Store	144	
16	Class Room 1	500	
17	Class Room 2	750	
18	Class Room 3	750	
19	Class Room 4	750	
20	Class Room 5	750	
21	Girls Common Rooms	250	
22	Staff room	250	
23	Secretary Cabin	96	
24	Play Ground	10000	
25	Open space	2000	
		24481 Sq. ft	2370 sq mt

Note: The present physical infrastructure will transfer early in newly Constructed Building (dimension as below)

New Building Area in Square Feet

Sr.No	Physical Infrastructure	Area in Sq. Ft	Remark
01	Principal Cabin	750	
02	Dept. of Chemistry & laboratory	750	
03	Dept. of Botany & laboratory	750	
04	Dept. of Zoology & laboratory	750	
05	Dept. of Physics & laboratory	750	
06	Dept. of Electronics & laboratory	750	
07	Dept. of Microbiology & laboratory	750	
08	Dept. of Computer Science & laboratory	750	
09	Dept of B. Voc. (Skill Lab)	750	
10	Library	750	
11	Reading Room	750	
12	Office	750	
13	Auditorium	1500	
14	Staff & Common Room	750	
15	Mathematics & IQAC Room	250	
16	NSS & Sports	250	
17	Class Room 1	750	
18	Class Room 2	750	
19	Class Room 3	750	
20	Class Room 4	750	
21	Class Room 5	750	
22	Lavatory Girls	300	
23	Lavatory Girls	300	
24	Drinking water area	300	
25	Store Room	750	
26	Womens Hostel	4592	
27	Play Ground		
28	Open space		
29	Garden		
	Total Built up Area	21742 Sq. ft.	6 Acres
		2020.63 sq mt	

Skill Lab Photo Gallery



Working Skills Lab

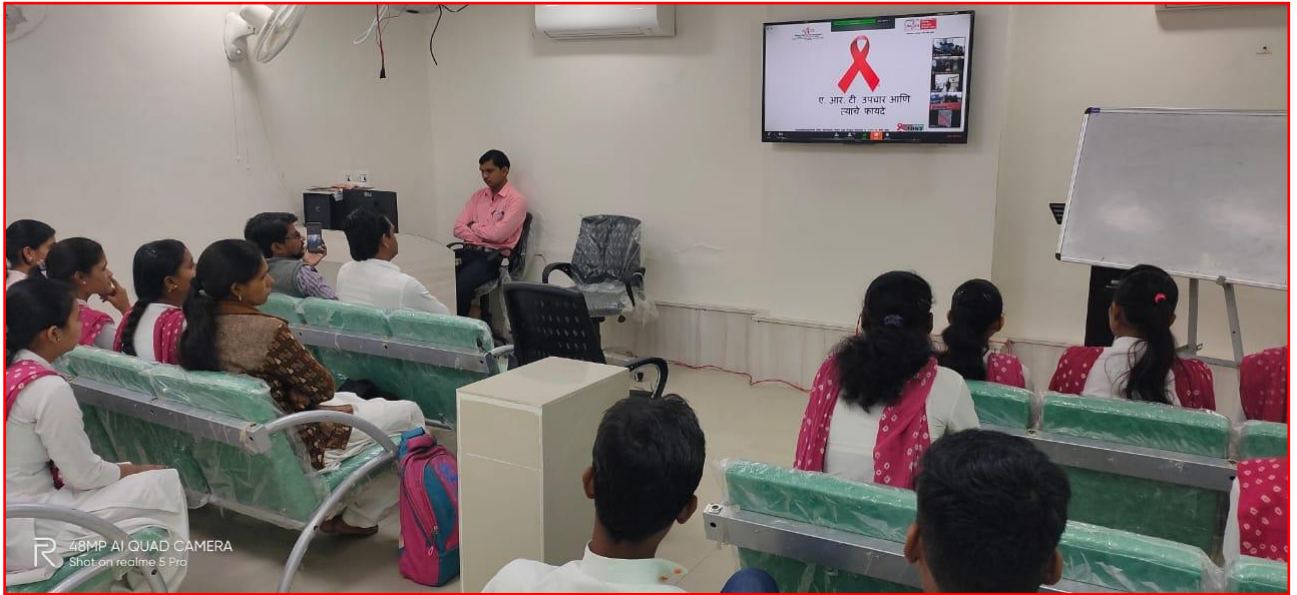

Online AIDS Workshop progress In the Skill Lab

Amrut Sevabhavi Sanstha Parbhani
Late Ku.Durga K.Banmeru Science College Lonar
Dist.Buldana -443302
Girls Common Room Photo Gallery



Girls Common room



Vending Machine available for sanitary napkins



Seating Rooms



XGMP+5P4, Wadgaon, Lonar, Maharashtra 443302, India

Lonar
Maharashtra
India

2023-01-31(Tue) 05:04(pm)



28°C
82°F

Lavatory Rooms

Amrut Sevabhavi Sanstha Parbhani
Late Ku.Durga K.Banmeru Science College Lonar
Dist.Buldana -443302
Department of Computer Science Photo Gallery





GPS Map Camera

Lonar, Maharashtra, India
2, Sarafa Bazar Rd, Sahkar Nagar, Lonar,
Maharashtra 443302, India
Lat 19.983549°
Long 76.523776°
30/12/22 12:59 PM GMT +05:30



GPS Map Camera

Lonar, Maharashtra, India
2, Sarafa Bazar Rd, Sahkar Nagar, Lonar,
Maharashtra 443302, India
Lat 19.983574°
Long 76.52382°
30/12/22 12:44 PM GMT +05:30

Department of Computer Working Lab



Computer Lab Smart Board

Amrut Sevabhavi Sanstha Parbhani
Late Ku.Durga K.Banmeru Science College Lonar
 Dist.Buldana -443302
Department of Chemistry Photo Gallery

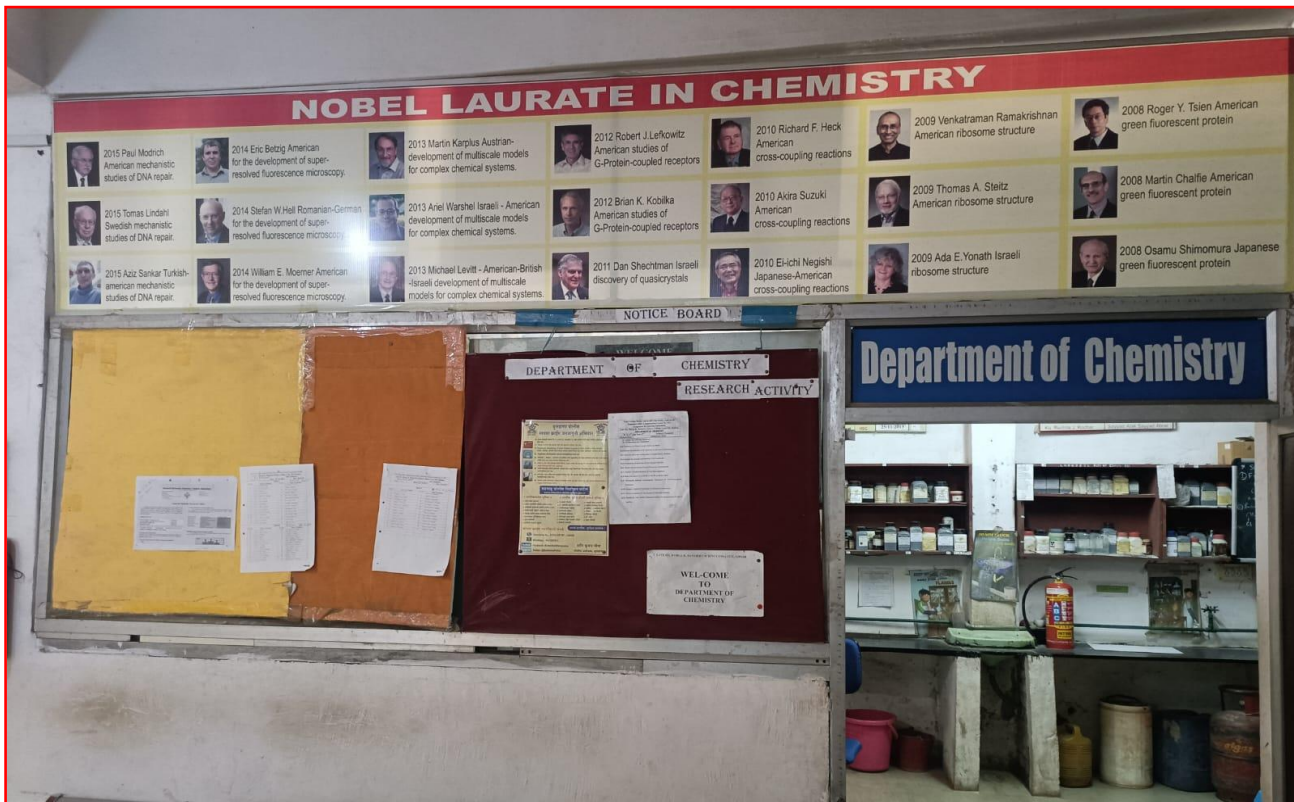



Practical Table



Glassware Apparatus



Solid Chemicals



Model kit, Charts Stopwatch



Gas



Fire Extinguisher



Basin



Water Tap



Hot Air Oven

Amrut Sevabhavi Sanstha Parbhani
Late Ku.Durga K.Banmeru Science College Lonar
 Dist.Buldana -443302
Department of Electronic Photo Gallery





Cupboard





Electronics Instrument

Amrut Sevabhavi Sanstha Parbhani
Late Ku.Durga K.Banmeru Science College Lonar
Dist.Buldana -443302
Department of Physics Photo Gallery



Department of Physics



Charts, Apparatus



Physics Instrument

Amrut Sevabhavi Sanstha Parbhani
Late Ku.Durga K.Banmeru Science College Lonar
Dist.Buldana -443302
Department of Zoology Photo Gallery



Setting Arrangement



Laboratory Instrument



Specimen

Amrut Sevabhavi Sanstha Parbhani
Late Ku.Durga K.Banmeru Science College Lonar
Dist.Buldana -443302
Department of Microbiology Photo Gallery



Microbiology department



Apparatus in Microbiology



Chemical



Laminar air flow



Practical In Microbiology

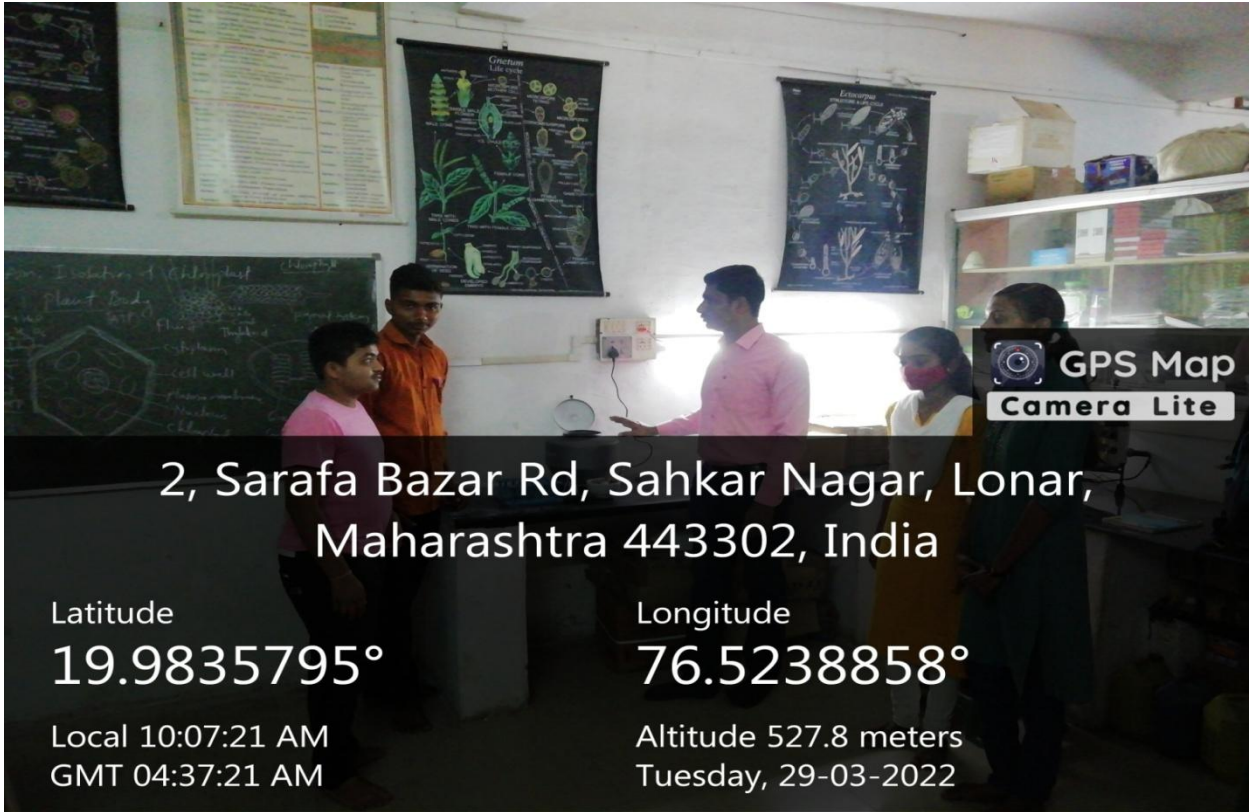

2, Sarafa Bazar Rd, Sahkar Nagar, Lonar,
Maharashtra 443302, India

Latitude
19.9835795°

Longitude
76.5238858°

Local 10:07:21 AM
GMT 04:37:21 AM

Altitude 527.8 meters
Tuesday, 29-03-2022

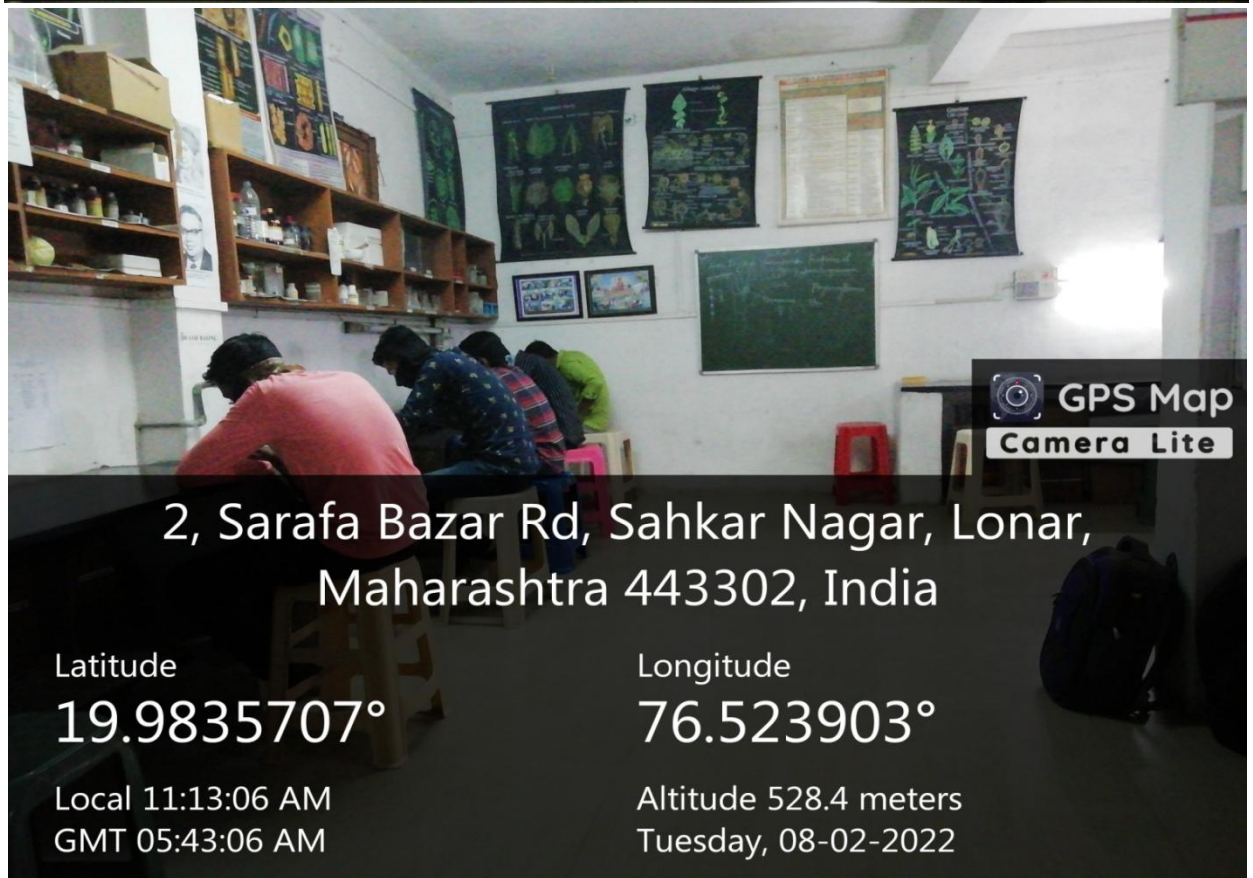

2, Sarafa Bazar Rd, Sahkar Nagar, Lonar,
Maharashtra 443302, India

Latitude
19.9835707°

Longitude
76.523903°

Local 11:13:06 AM
GMT 05:43:06 AM

Altitude 528.4 meters
Tuesday, 08-02-2022

Practical Demonstration



2, Sarafa Bazar Rd, Sahkar Nagar, Lonar,
Maharashtra 443302, India

Latitude
19.9835521°

Longitude
76.5238483°

Local 11:27:22 AM
GMT 05:57:22 AM

Altitude 528.9 meters
Tuesday, 08-02-2022

Amrut Sevabhavi Sanstha Parbhani
Late Ku.Durga K.Banmeru Science College Lonar
Dist.Buldana -443302
ICT Facility Photo Gallery





Smart Board With Projector

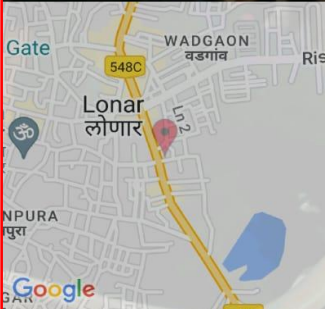

XGMP+JM6, Loni Rd, Lonai, Lonar, Maharashtra 443302, India

Lonar
Maharashtra
India

2022-10-21(Fri) 01:39(pm)



27°C

81°F



Skill Lab Lecture

Amrut Sevabhavi Sanstha Parbhani
Late Ku.Durga K.Banmeru Science College Lonar
Dist.Buldana -443302
Department of Sport and Cultural Photo Gallery



Volleyball



Lazim



Volleyball



Net Weight lift



Tennis



Thali



Cricket Helmet



Dum belled

Amrut Sevabhavi Sanstha Parbhani
Late Ku.Durga K.Banmeru Science College Lonar
Dist.Buldana -443302
Auditorium Photo Gallery



Auditorium



Auditorium Hall

Amrut Sevabhavi Sanstha Parbhani
Late Ku.Durga K.Banmeru Science College Lonar
Dist.Buldana -443302
Women Hoste Photo Gallery





Maharashtra, India
MSEB Rd, Maharashtra 443302, India
Lat N 19° 59' 50.14181"
Long E 76° 31' 40.32704"
16/10/20 03:06 PM

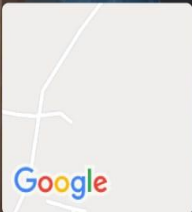

Maharashtra, India
MSEB Rd, Maharashtra 443302, India
Lat N 19° 59' 50.42244"
Long E 76° 31' 39.96222"
16/10/20 03:13 PM



Maharashtra, India
MSEB Rd, Maharashtra 443302, India
Lat N 19° 59' 50.48867"
Long E 76° 31' 39.94593"
16/10/20 04:02 PM



Maharashtra, India
MSEB Rd, Maharashtra 443302, India
Lat N 19° 59' 50.29163"
Long E 76° 31' 40.45136"
16/10/20 03:31 PM



Maharashtra, India
MSEB Rd, Maharashtra 443302, India
Lat N 19° 59' 49.60258"
Long E 76° 31' 40.32311"
16/10/20 02:55 PM

Ramp for Handicap student

**The present physical
infrastructure will transfer early
in newly Constructed Building
(Photographs as below)**

Amrut Sevabhavi Samstha Parbhani
Late Ku.Durga K.Banmeru Science College,
Lonar Dist-Buldana
New College Campus Physical Facilities
Principal Cabin



Chemistry Laboratory





Department of Microbiology

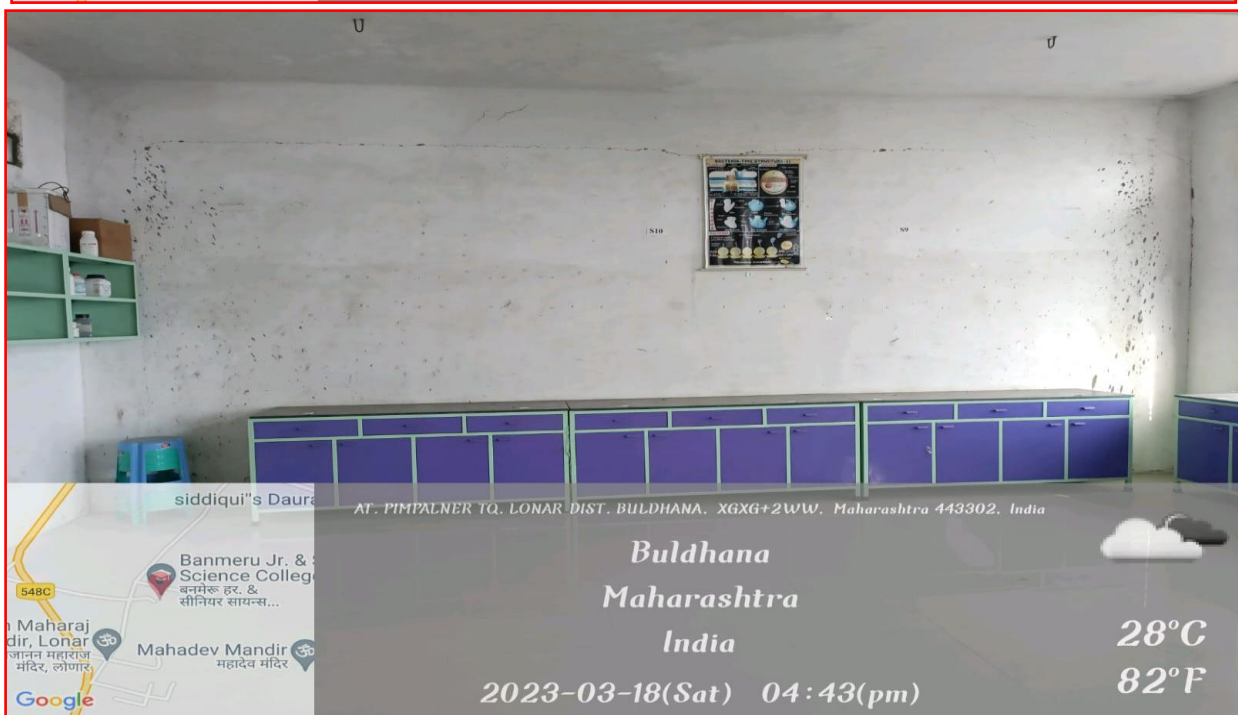

Department of Zoology



siddiqui's Daur AT. PIMPALNER TQ. LONAR DIST. BULDHANA. XGXG+2WW, Maharashtra 443302, India

Buldhana
Maharashtra
India

28°C
82°F

2023-03-18(Sat) 04:45(pm)



siddiqui's Daur AT. PIMPALNER TQ. LONAR DIST. BULDHANA. XGXG+2WW, Maharashtra 443302, India

Buldhana
Maharashtra
India

28°C
82°F

2023-03-18(Sat) 04:44(pm)

Department of Botany



Matoshri complex, near gojanan maharaj temple MSEB Rd, XGVG+XCG, Mehkar Rd, Lonar, Maharashtra 443302, India

Lonar
Maharashtra
India

2023-03-18(Sat) 04:46(pm)

28°C
82°F



AT. PIMPALNER TQ, LONAR DIST, BULDHANA, XGXG+2WW, Maharashtra 443302, India

Buldhana
Maharashtra
India

2023-03-18(Sat) 04:47(pm)

28°C
82°F

Department of Physics



siddiqui's Daur AT. PIMPALNER TQ. LONAR DIST. BULDHANA. XGXX+2WW, Maharashtra 443302, India

Buldhana
Maharashtra
India

28°C
82°F

2023-03-18(Sat) 04:48(pm)

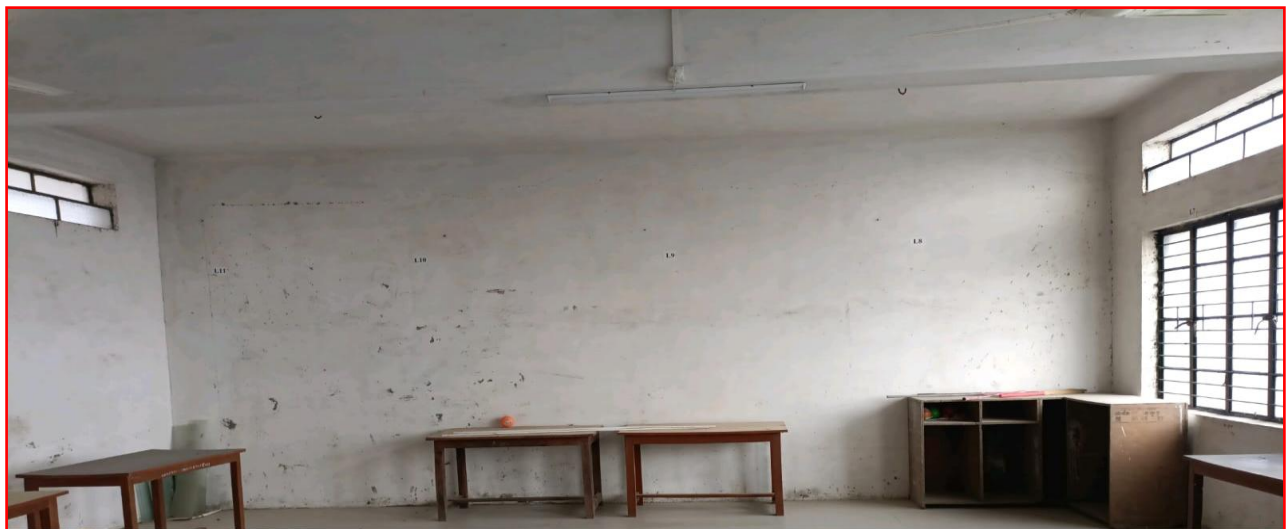

siddiqui's Daur AT. PIMPALNER TQ. LONAR DIST. BULDHANA. XGXX+2WW, Maharashtra 443302, India

Buldhana
Maharashtra
India

28°C
82°F

2023-03-18(Sat) 04:50(pm)

Water Cooler

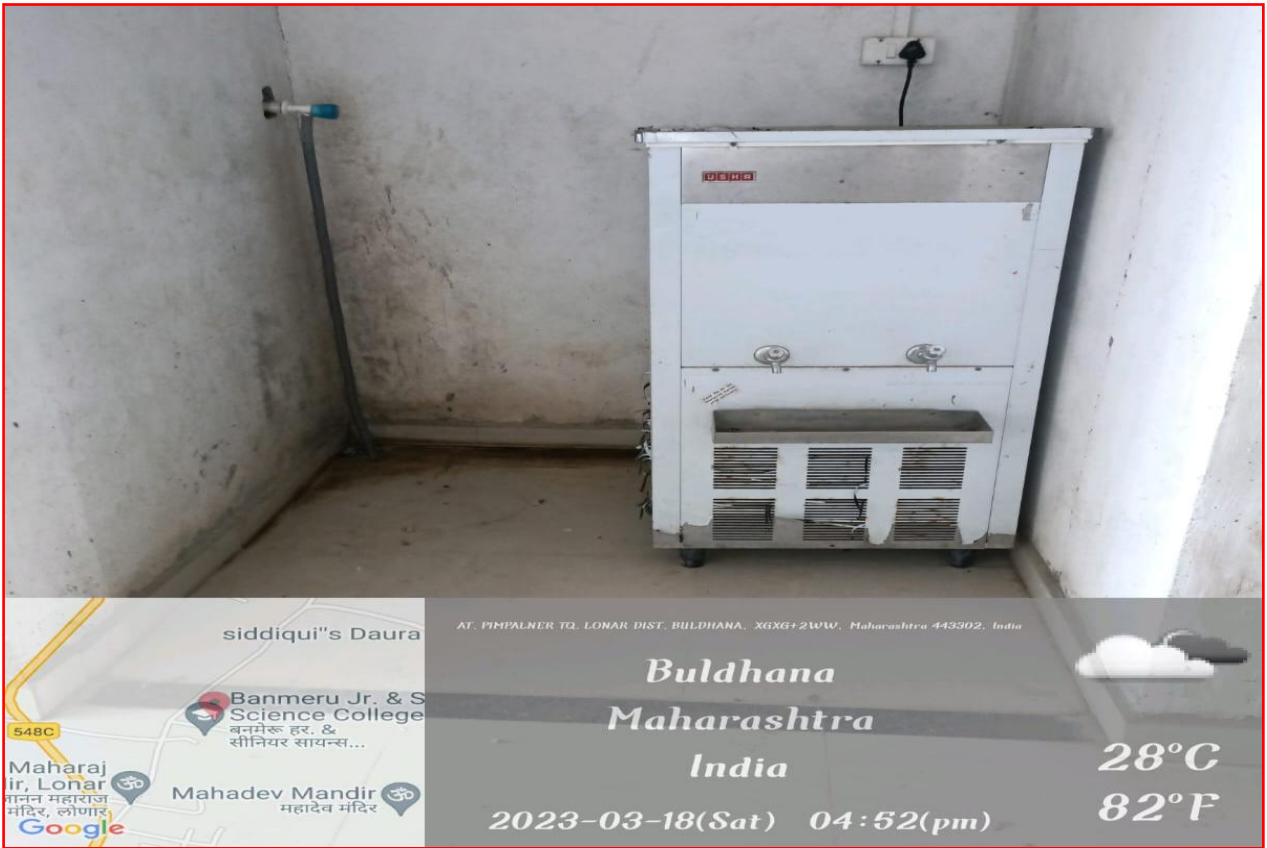

Ladies Toilet

Gents Toilet



Auditorium Hall





Student Open Gym





 Principal
 Late. Ku. Durga K. Banmeri Science College
 LONAR, Dist. Buldhana